

STANDARD OPERATING PROCEDURE

EQUIPMENT INSTALLATION: **ULTRA-M DISSOLVER**

READ MANUAL FOR COMPLETE DETAILS

WEAR APPROPRIATE PPE

WATER SOURCE REQUIREMENTS

- Use only same source makeup water
- Filter water using a minimum 80 mesh screen
- Pressure range: 25-120 psi
- Temperature range: 40-100F
- Flow Minimum: 1.0 gpm

TOOLS NEEDED

- Tubing
 - 3/8" OD for both inlet and outlet
 - 1/2" ID for overflow drain
- Mounting Hardware
 - Masonry screws (3/16 x 2 1/2" if needed for solid wall)
- Additional items
 - Drill
 - Drill bits (1/2" if using supplied toggle anchors or 5/32" for masonry)
 - Phillips screwdriver
 - Level
 - Tape measure
 - PTFE tape
 - Socket driver (9/16" for disc conversion)

STEPS:

1. Install outlet ball valve and overflow barb fitting into bottom of reservoir.
 - a. Apply Teflon tape to the threads.
 - b. Tighten hand tight only.



2. Mount wall bracket on wall.
 - a. Use included toggle bolts if mounting to dry wall.
 - b. Use masonry screws if attaching to a solid wall.
 - c. Bracket must be installed on a surface that can hold 50lbs.



3. Slide dissolver bottom onto wall bracket.

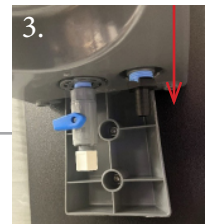

4. If using discs:
 - a. Remove the black bottle nozzle using a 9/16" socket.
 - b. Install the white disc nozzle. Do not over-tighten.
 - c. Place disc screen on top with screen side up.

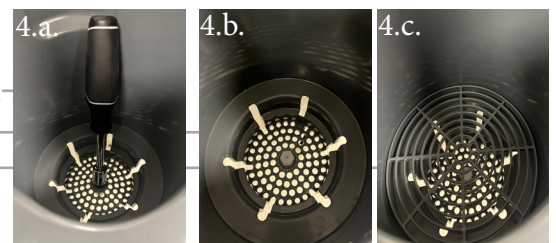

CONTINUED

STANDARD OPERATING PROCEDURE

EQUIPMENT INSTALLATION: ULTRA-M DISSOLVER

5. Add float to water valve by pushing the clip onto the yoke.
a. Pull down on the yoke a few times to ensure it operates smoothly.

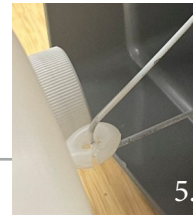

6. Attach top of unit to bottom.

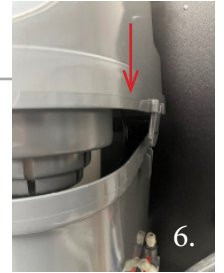

7. Connect inlet ball valve to fresh water source using 3/8" OD tubing.

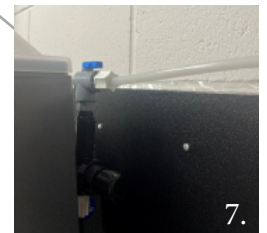

8. Check for proper operation.
a. If using bottles, place bottle in the reservoir without removing the cap.
b. If using discs, place the black spray diverter on the screen.
c. Turn on water source.
i. Check for leaks.
ii. Listen for operation of water valve.
iii. Confirm float valve shuts off and reservoir stops filling (~90 sec.)

9. Turn off water source and open the outlet ball valve to completely drain the reservoir.

10. Add chemical to the system.

(see *Standard Operating Procedure for Bottles/Discs* for additional details)

- a. If using solid chemistry bottles, remove the entire screen cap assembly prior to inserting the bottle.
b. If using bottles with granules, remove only the screen cap prior to inserting the bottle.
c. If using discs, remove the black spray diverter from the dissolver, remove the plastic covering from the discs, place the discs into the dissolver, and then place the black spray diverter on the top disc.



11. Connect outlet ball valve to pump using 3/8" OD tubing.

12. Connect overflow barb to drain using 1/2" ID tubing.



13. Turn on water source.
a. Check for leaks.
b. Listen for operation of water valve.
c. Confirm float valve shuts off and reservoir stops filling (~90 sec.)

14. Test for appropriate solution strength.