

Troubleshooting Chart:

Problem	Cause	Solution
1. System does not operate	a. No water b. Clogged water inlet strainer c. Primary float valve failure d. No power	a. Open water supply b. Disconnect inlet water line and clean strainer c. Clean* or replace with valve parts kit Drain overflow reservoir to resume operation d. Check power supply
2. Discharge from backflow preventer	a. Failed backflow preventer b. System pressure too low	a. Repair or replace backflow preventer b. Minimum 25 psi required
3. System not switching sides	a. Probes are dirty	a. Clean probes

* Hard water may cause build-up of mineral deposits in water valve. Remove deposits by soaking the valve parts in a deliming solution.



591 Continuous Feed Solid Dissolver

- Package Should Contain:**
1. Dissolver Board
 2. Floats (2)
 3. Water inlet Assembly
 4. Solution Outlet Ball Valve
 5. Mounting Kit
 6. AC adapter
 7. Instruction Manual

THANK YOU FOR YOUR INTEREST IN OUR PRODUCTS

Please use this equipment carefully and observe all warnings and cautions.
*****NOTE*****

WEAR	protective clothing and eyewear when dispensing chemicals or other materials or when working in the vicinity of all chemicals, filling or emptying equipment, or changing metering tips.
ALWAYS	observe safety and handling instructions of the chemical manufacturer. direct discharge away from you or other persons or into approved containers. dispense cleaners and chemicals in accordance with manufacturer's instructions. Exercise CAUTION when maintaining your equipment. reassemble equipment according to instruction procedures. Be sure all components are firmly screwed or latched into position.
KEEP	equipment clean to maintain proper operation.

UNIT SPECIFICATIONS:

- Weight: -- 35lb. Dry
 -- 55lb. With full chemical bottle and full solution reservoir
- Dimensions: -- 35" W X 27" H X 10" D
- Water inlet pressure: -- 25 psi. minimum
 -- 80 psi. maximum

Installation and Operation:

1. Drill holes for the four wall anchors with a (9/32") drill, using the mounting board as a template. Make sure the board is level.
2. Remove the water inlet assembly by loosening compression fitting and opening pipe hangers.
3. Remove the doors on either side of the board to gain access to the internal components.
4. Install the 2 floats on the hooks inside the board.
5. Re-install the water inlet assembly by attaching the compression fitting and pushing the assembly into the pipe hangers.
6. Install the solution outlet ball valve into the threaded fitting on the bottom of the reservoir.
7. Connect water supply line to the water inlet ball valve compression fitting and tighten.
8. Connect the outlet supply line to the solution outlet ball valve compression fitting and tighten.
9. Place chemical bottle securely in solid bowl assembly.
10. Turn on water supply valve.
11. Open solution outlet ball valve.
12. Connect the AC adapter to the open slot in the rear of the control box.
13. Plug the AC adapter into a 115V outlet.
14. The float valves will call for water to be sprayed into one of the solid bowls.
15. When one chemical jar is empty, the unit will automatically switch to the other.
(Lights on the control box will signify which bowl is active)
16. If both bowls are determined to be empty, the system will monitor both bowls until a new bottle is added.



SOLID DISSOLVER Parts Diagram and List:

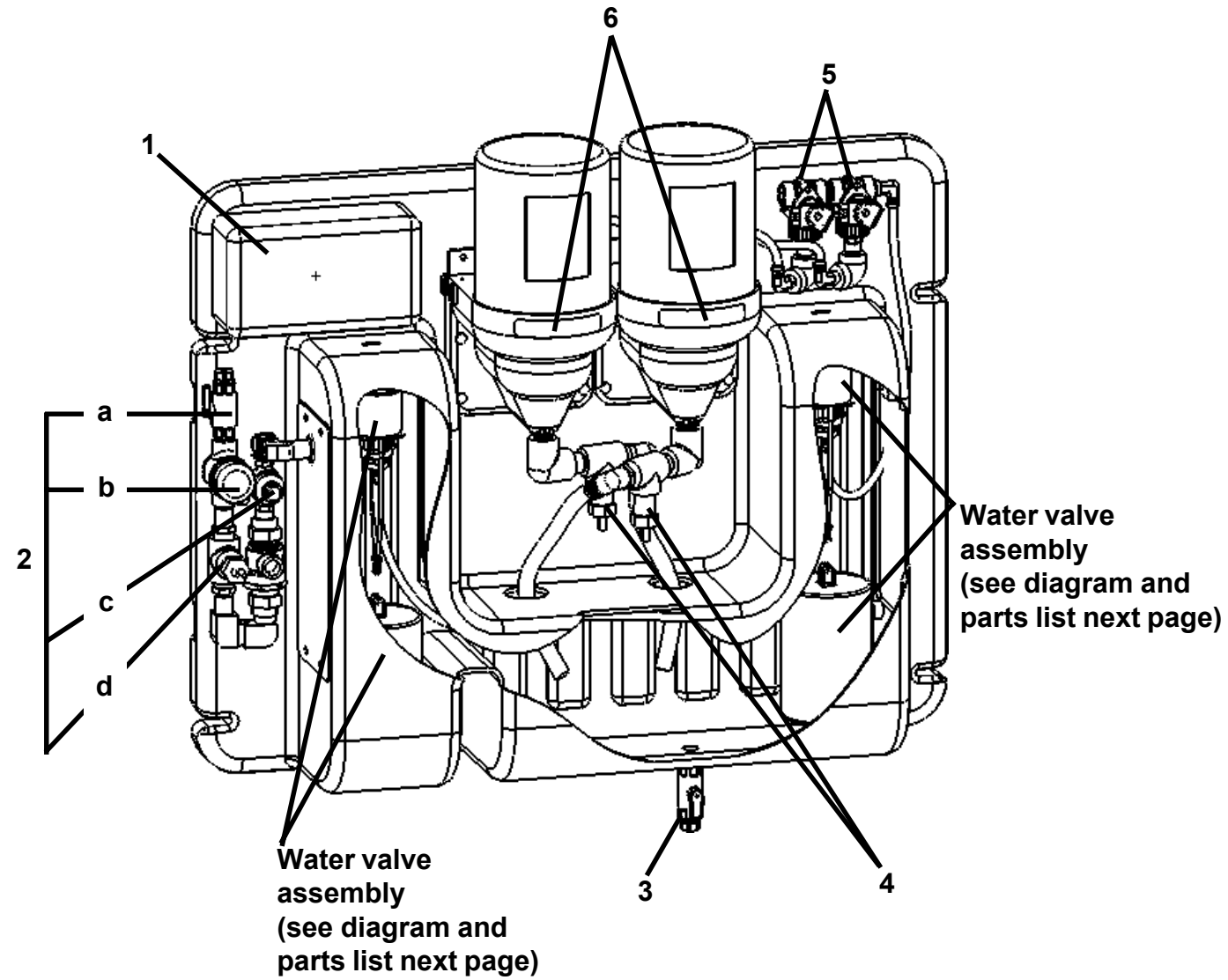

Key	Part No.	Description
1	10091156	Control box
2		Water inlet assembly
a	90085153	Water inlet ball valve
b	90085154	Strainer
c	90085155	Pressure regulator/gauge
d	10091164	Conductivity probe
3	90085153	Ball valve, solution outlet
4	10091164	Conductivity probes
5	10039409	Valve parts kit
	3266-3	Coil, 24V
6	90086212	Solid bowl assemblies

Water Valve Parts Diagram and List:

Key	Part No.	Description
1	5051-K	magnet parts kit a. screw b. washer c. magnet cover d. magnet cap e. magnet f. magnet spring g. magnet yoke
2	6655-K	valve parts kit h. valve guide assembly i. armature spring j. armature k. diaphragm
3	520000	water valve body
4	5043-A 507200	float & chain assembly bead chain only

